

OVENS



Drying Oven for Coating Lines - mod. FOP/C 3,80m modular bays

Drying Oven for Coating Lines mod. FOP/C main features:



- **Heating system**, equipped with one re-circulation fan, one oil battery, blowing channels, air recovery channel and filter. To ensure uniform heating and air distribution, fields are opposed on left and right side.
In order to reduce electrical consumption as the oven reaches working temperature, all re-circulation fans are controlled by an inverter wich changes rotation speed as temperature increases
- **Oven structure**, with silicone rubber sealing doors placed all along the sides, in order to grant easy inner access. Side doors as well as upper coverings are made of sheet-zinc panels containing high-density rock-wool. **The oven is built in order to guarantee maximum sealing and insulation**
- **Air exhaust system**, consisting of upper exhausters connected to two air channels placed outside the oven along the upper sides. In order to allow local and precise air suction adjustments, variable size openings are provided for every field
- **Conveyor belt** made of a kevlar net, and equipped with:
 - automatic system to adjust alignment and tensioning
 - supporting idle rolls
- **Electrical board & PLC**. Motorization components are gathered on modular control panels. Main functions are displayed on screen. Synchronization with the rest of the line is obtained through inverter controlled A.C. motors with vector function. General synchronization is obtained through an input signal to the cards controlling the inverters. General speed adjustment is obtained through moto-potentiometer and signal amplifier. Electronic cards for inverter adjustment are equipped with potentiometric correction in percentage

>>



OVENS

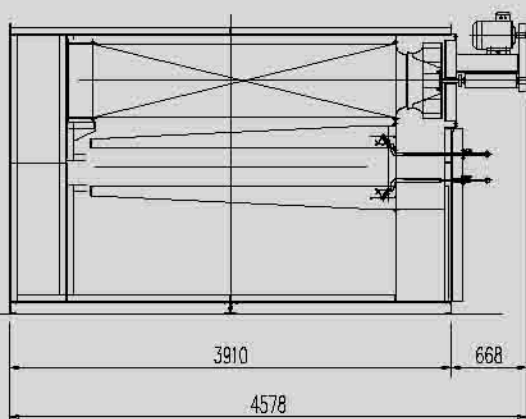

- **Thermo-Regulations mod. TR**, with temperature control system, one for each battery, consisting of:
 - three-way pneumatic command modular valve, equipped with electro-pneumatic transducer
 - PT 100 temperature detector
 - PID electronic control with digital display.

Options:

Paper introduction system: the oven can be equipped with a motorized chain conveyor, to easily introduce paper that requires coating. Idle cylinders are provided in order to support paper along the oven. The cylinders can be easily removed for cleaning.

AIGLE ovens can also be built with steam or gas heating.

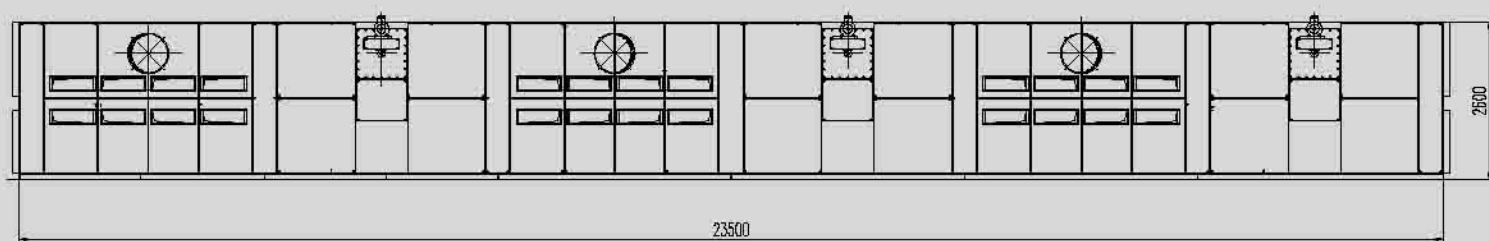

TECHNICAL DATA

Oven heating	diathermic oil
Thermic oil temperature	280°C
Single bay heating power	120.000 KCal/h
Single recirculation fan electrical power	5,5 Kw
Max. working temperature	to be agreed upon (220° C max.)
Useful width	to be agreed upon
Power supply	400 V/50 Hz/three-phase
Compressed air	7±1 Kg/cm ²



ISO 9001:2000
Certified Quality System
IT-50269

