

FLOCKING LINE

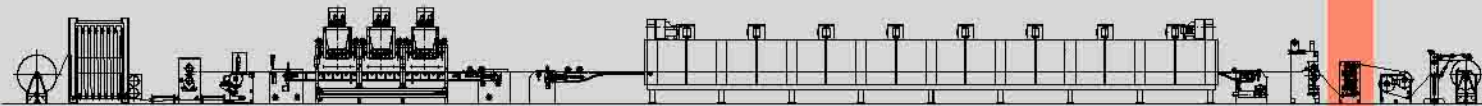

Brushing Unit - mod. SZ2



The **Brushing Unit mod. SZ2** consists of:

- Two rotating brushes with "beater-bar" effect, opposed to the flocked fabric and with adjustable pressure. In order to avoid flock dispersion, the brushes are sealed inside suction chambers
- Two A.C. motors with a system of belts and pulleys for brush rotation
- Flock recovery system equipped with sleeve filters and a suction fan connected to the brushes chambers.

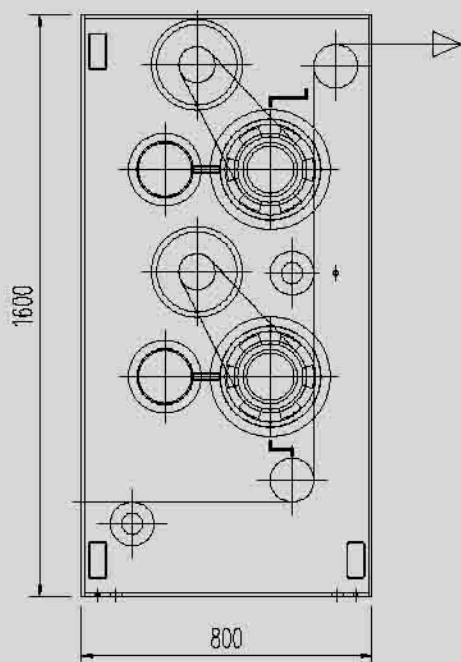

TECHNICAL DATA

Useful width	max. 3400 mm
Mechanical speed	40 m/min. max.
Power supply	400 V/50 Hz/three-phase
Installed power	4 Kw



ISO 9001:2000
Certified Quality System
IT-50269

AIGLE